



# BUBBLE CPAP SYSTEM

CODE 234



This product has been designed to administer a mixture of air/oxygen with positive pressure in spontaneously breathing neonatal patients.



100% clear silicone cannula. Adaptable to nostrils.

- Does not cause pressure injury to the nasal septum.
- Adaptable to bubble CPAP or ventilator.
- Replacement parts help reduce costs.
- Allows even heat distribution, avoiding that this is lost and that condensation accumulates.
- Corrugated tubes. They allow mobility without kinking.
- System of locks. ensure the correct position of the tube inside the bottle.
- Great stability of the container

kit:

- (A) 2 corrugated tubes..
- (B) Pressure monitoring line (PEEP).
- (C) 2 adapters for humidification from 22 mm to 10 mm.
- (D) 1 cap luer lock for closing.
- (E) 1 double luer slip adapter.
- (F) 1 standard connector 15 mm.
- (K) Flexible tube.
- (L) Rigid container for pressure generation.

Fixation system for the cannula:

- (G) 1 yarn cap (cotton).
- (H) 2 insurance with double lock
- (I) 2 fastening tapes.
- (J) 1 Hydrocolloid and velcro.

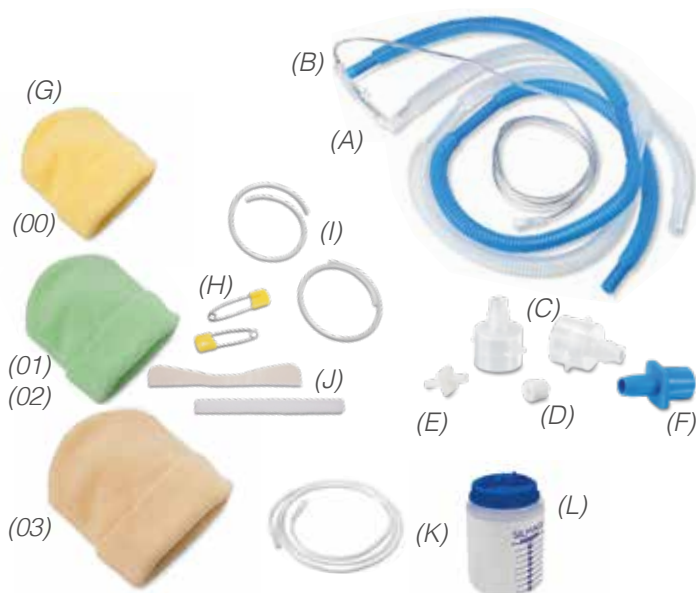

Connection scheme



System of locks  
Rigid container for pressure generation

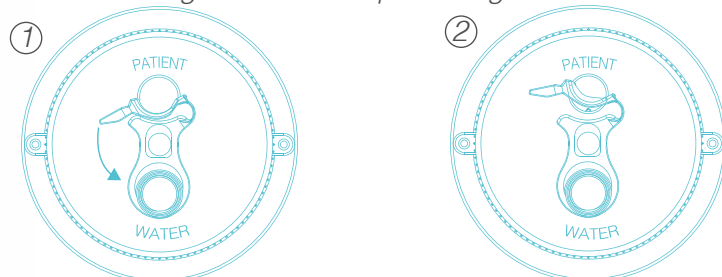

1. Slide the lock in the indicated direction to

2. Release lock to fix the tube in the desired PEEP.

Burbble CPAP system code	Size (FR)	Cannula Ø (mm)	Distance between cannulas (mm)	Cannula length (mm)	Recommendation based on patient weight	Color cap
234-00	8,0	2,70	2,70	9,00	Less than 1000 g	Yellow
234-01	10,0	3,30	2,70	9,00	1000 to 1500 g	Green
234-02	12,0	4,00	4,00	10,00	1500 to 2000 g	Green
234-03	15,0	5,00	4,50	12,50	2000 to 3000 g	Brown